

Recommended P.C.B Layout(Top Side)
(PCB BOARD TOLERANCE±0.05)

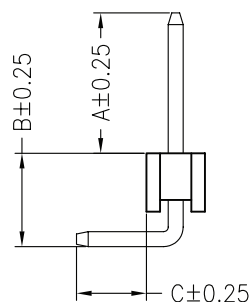
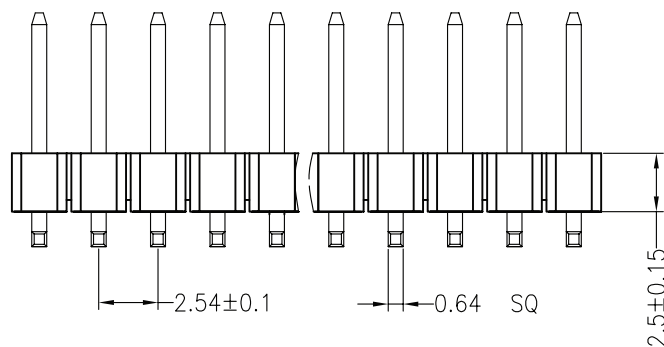
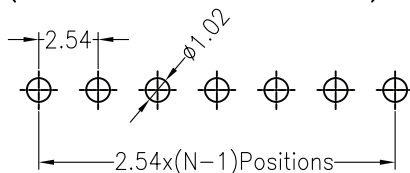

SPECIFICATIONS

Rated Current:3.0AMP
 Contact Resistance:20mΩ Max
 Withstand Voltage:1000V AC/DC
 Insulation Resistance:1000MΩ Min
 Operation Temperature:-40°c to +105°c
 Contact Material:Brass
 Contact Plating:Au Over Ni
 Insulator Material:Polyester(UL94V-0)
 Standard: PA6T
 Max.Processing Temp: 230°C for 30-60 seconds
 (260°C for 10 seconds)

General description of ordering code

FAMILY	PITCH	N° ROWS	N° PIN P.R.	VERSION	CLIP PLATING	*HEIGHT	OPTION	TYPE	PACKAGE	- A/B/C [mm]
PH	254	1	XX	R [right angle]	F [flash gold] G [gold 10u]	XXX [length A]	A [insulator 2.50 mm]	00	T [tube] V [bag/tray]	

*Height standard A- mm 6,00[XXX=060]
 B- mm 4,40
 C- mm3,00



euro-conn



UNITS: mm

SHEET SIZE: ISO A4

UL E356435

> 0 ~ 3
± 0.12

> 3 ~ 18
± 0.15

> 18 ~ 50
± 0.3

> 50 ~ 120
± 0.5

! I prodotti e le caratteristiche possono cambiare senza preavviso.
 The products and their features may change without notice.

HEADER