

Technical Specs:

Insulator: glass filled polyester PPS/PBT
 Flammability: UL 94V-O
 Sleeve: Brass
 Contact clip(4/6 finger): Beryllium copper(C17200)
 Accepted pin: $\varnothing 0.40$ to 0.56mm
 Forces: (polished steel gauge $\varnothing 0.43\text{mm}$)
 -Insertion: 2 N typ
 -Withdrawal: 1 N typ
 Mechanical life: min500 cycles
 Rated current: 3A
 Contact resistance: max $10\text{m}\Omega$
 Dielectric resistance: Min 1000V RMS
 Coplanarity SMD: max 0.1 mm (measured on terminations: 25 mm long connectors)

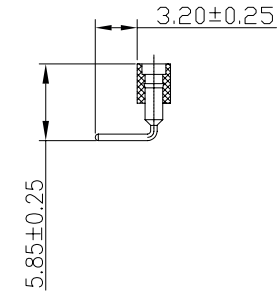
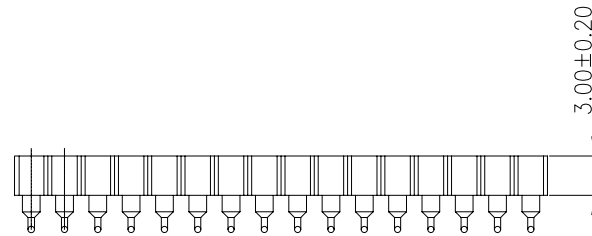
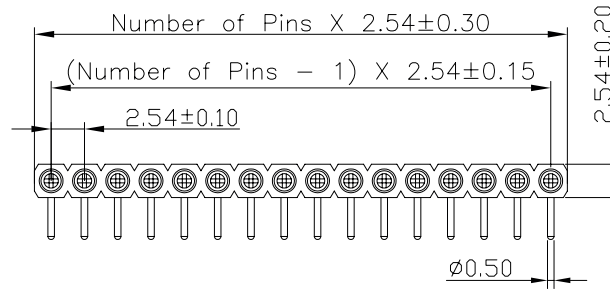

General description of ordering code

FAMILY	TYPE	PITCH	N° PIN PER ROW	VERSION	CLIP PLATING	PACKAGE
ZH	0 [single row 2,54]	254	XX [01 ≤ XX ≤ 36]	R [right angle]	F [flash gold]	T [tube]
						T [tin] V [tray]



euro-conn



UNITS: mm

SHEET SIZE: ISO A4

SCALE:---



First angle projection

> 0 ~ 3

> 3 ~ 18

> 18 ~ 50

> 50 ~ 120

± 0.12

± 0.15

± 0.3

± 0.5

IC-SOCKET